

Proposed Proposition 39 Alternative Facilities Use Agreement with Academy of Alameda Charter Schools

Chad Pimentel
General Counsel

April 12, 2016

Proposition 39 Basics

- Entitles charter schools to space in district facilities.
 - Space is allocated based on number of in-district students reasonably projected to attend the charter.
 - Facilities must be “reasonably equivalent” to those provided to students in comparable district schools.
- AoA Elementary and AoA Middle are the only schools participating in the Prop 39 process for next year.
- Prop 39 permits districts and charters to negotiate alternative facilities use agreements instead of relying on Prop 39 calculations.

AoA Schools' Current Space

- Reached agreement with District last year on the Academy's continued use of the Chipman campus.
- Middle School currently has:
 - Exclusive use of seventeen (17) regular classrooms.
 - Exclusive use of six (6) specialized teaching spaces (music room, two (2) science rooms, art room, cooking room, industrial arts room) plus the school's designed office space.
 - Shared use of one (1) specialized teaching space (gym/MPR).
 - Dedicated storage space.
- Elementary School currently has:
 - Exclusive use of four (4) regular classrooms.
 - Storage space.

AoA Schools' Prop 39 Requests

- Middle School sought:
 - Exclusive use of nineteen (19) regular classrooms.
 - Two (2) more than current use.
 - Continued exclusive use of six (6) specialized teaching spaces (music room, two (2) science rooms, art room, cooking room, industrial arts room) and the school's designed office space.
 - Exclusive use of media center.
 - Not included in current use.
 - Shared use of one (1) specialized teaching space (gym/MPR).
- Elementary School sought:
 - Exclusive use of six (6) regular classrooms.
 - Two (2) more than current use.

AUSD Adult School

- Provides English as Second Language, Family Literacy, and GED/High School Diploma classes to students over 18 years of age.
- Currently uses seven (7) rooms at Chipman.
 - Six (6) classrooms with morning and evening uses.
 - Media center, which houses Adult School's office and administrative staff.
- State and local priority:
 - Parcel tax program
 - Restored state funding

District's Preliminary Offers

- Middle School preliminary offer (at Chipman):
 - Exclusive use of nineteen (19) regular classrooms
 - Increase of two (2) rooms.
 - Retain current exclusive use of six (6) specialized teaching spaces and the school's designed office space.
 - Continue current shared use of gym/MPR.
 - Retain current dedicated storage space.
- Elementary School preliminary offer:
 - No space, based on District's position that the school had not substantiated an in-district ADA over 80.
 - Elementary school has since held admissions lottery.

Proposed Alternative Agreement

- Basic idea: hold everyone harmless.
- Adult School continues to operate in same space next year.
- Academy schools collectively continue to operate in current space as well.
 - Some rooms traded between middle and elementary schools.
- Other terms identical to current facilities use agreement in place between the parties.
- One-year agreement.
- Academy board has already approved.

Proposed Alternative Agreement: Site Map

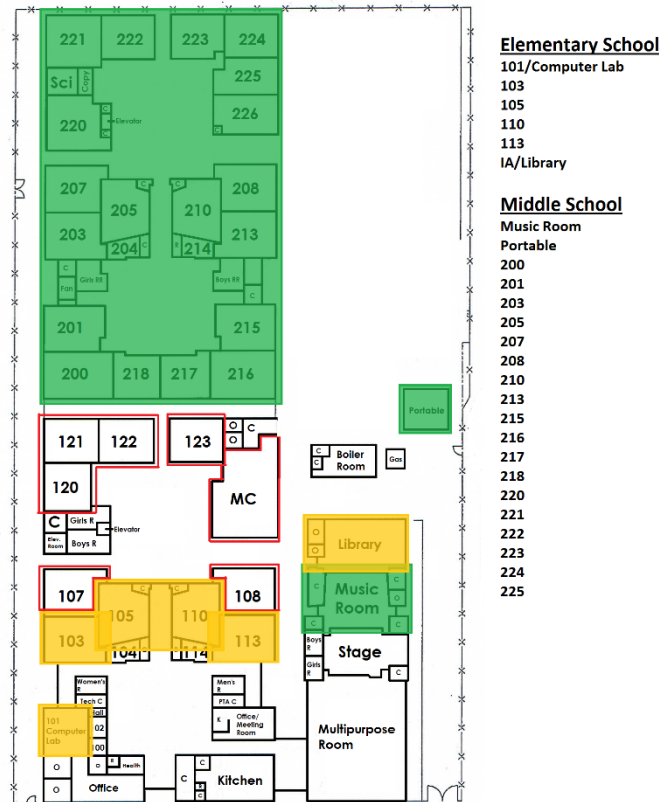

Questions?